

# COOLING SYSTEM CAP, COOLANT RESERVE TANK CONSTRUCTION

B3E011201008T07

- A low-pressure type cap has been adopted for the cooling system cap. It is installed on the coolant reserve tank to improve serviceability when adding engine coolant and bleeding air.
- A degassing type coolant reserve tank has been adopted, to integrate the simple airtight sub-tank and the air/water separating tank, improving the air/water separating function. The integrated and large-size degassing tank consists of a labyrinth structure with internal barriers to lengthen the distance to the outlet and reduce the flow speed to lengthen the time the engine coolant has to accumulate, improving the air/water separation function.

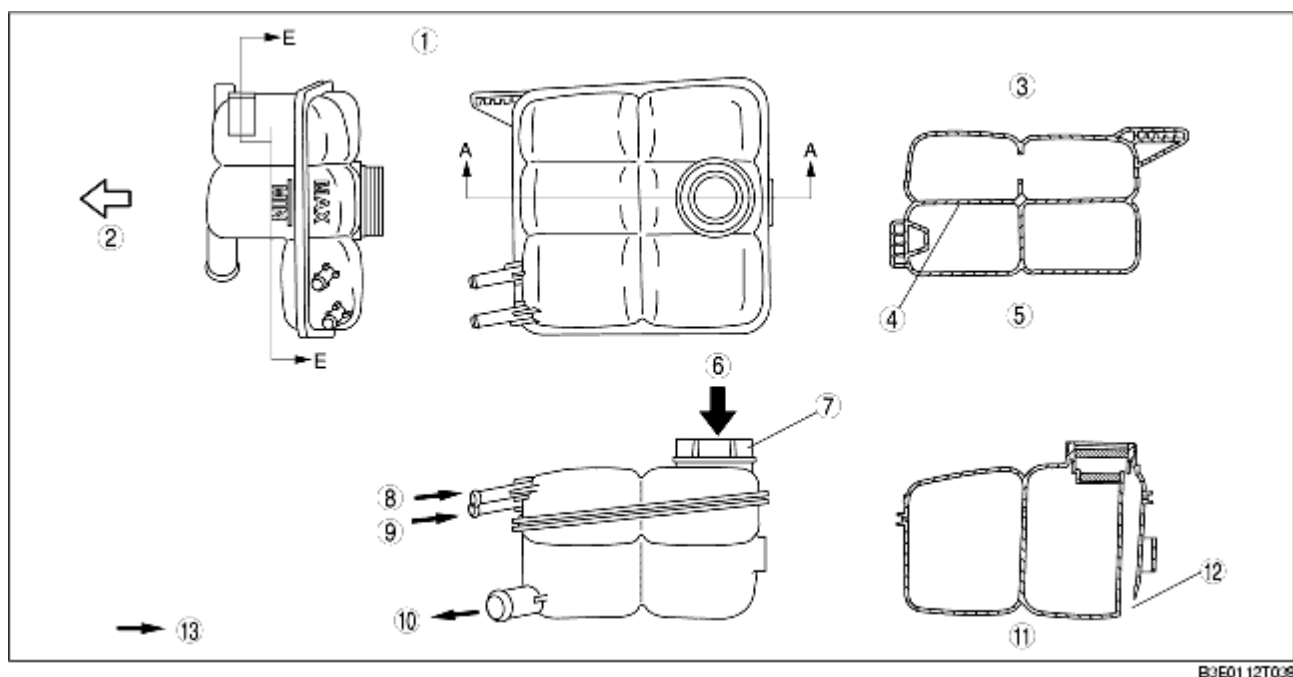

B3E01 12T038

1	External view
2	Front
3	Labyrinth structure
4	Barrier
5	Sec. E-E
6	Cap pressure
7	Cooling system cap
8	Water outlet
9	Radiator
10	To lower radiator hose
11	Sec. A-A
12	Passage for coolant over flow
13	Engine coolant flow